

Discover Our New Location!!

Dec 1st

PLACER TOWN & COUNTRY VILLAGE

SEC N. SUNRISE AVENUE & SIERRA GARDENS DRIVE • ROSEVILLE, CA

Just Up The Road
from the office that has
been our home for 5 Years

You will LOVE the Beautiful
setting with its fountains, trees
and tranquil pathways.

Directions:

Granite Bay: take Douglas West
Turn right on Sierra Gardens
Turn Left in to North Lot

Bay Area/Sacramento:

Exit I80 at East Douglas
Turn Left at Sunrise (1st Light)
Turn Right at Sierra Gardens
Turn Right into the North Lot

Folsom/ElDorado Hills: Exit I50 Hazel

Take Hazel to Roseville, Turn Left on
Douglas Blvd. Turn Right on Sierra
Gardens. Turn Left in to North Lot

Look for the
BloodSource sign
& we're right upstairs!

For Wheelchair

Access: Park in south lot
Under the red **State Farm** Sign
and take the elevator to the 2nd floor.
Turn left and follow walkway to #1014

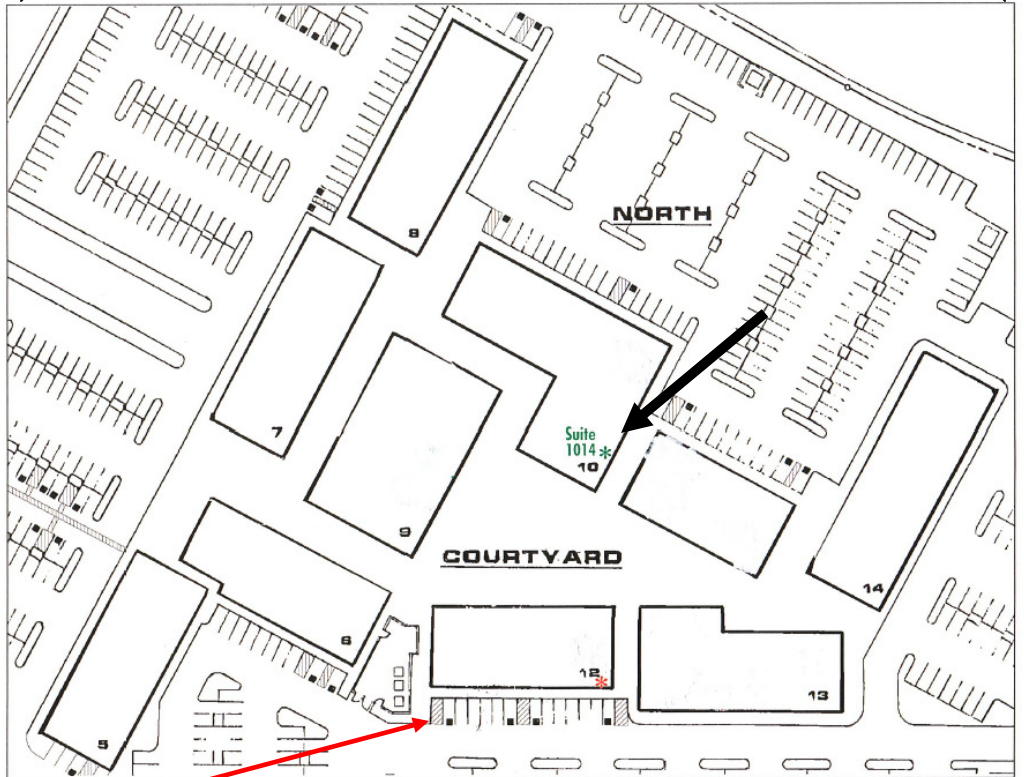
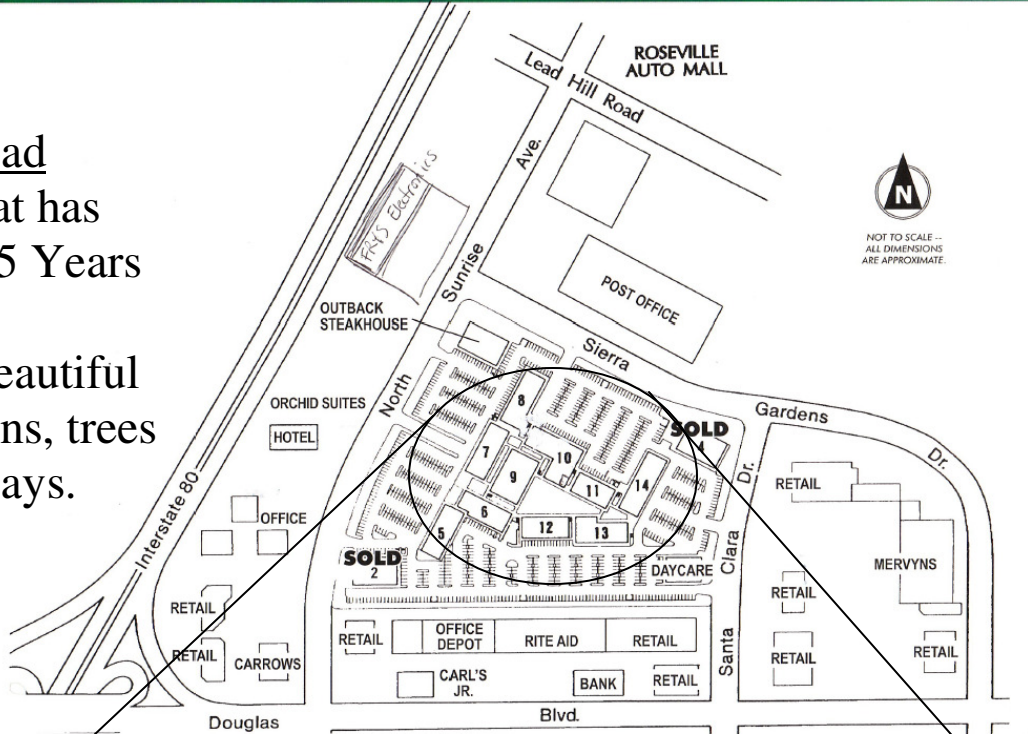

■ Second Floor